

**A** REFERENCE PLAN  
N.T.S.

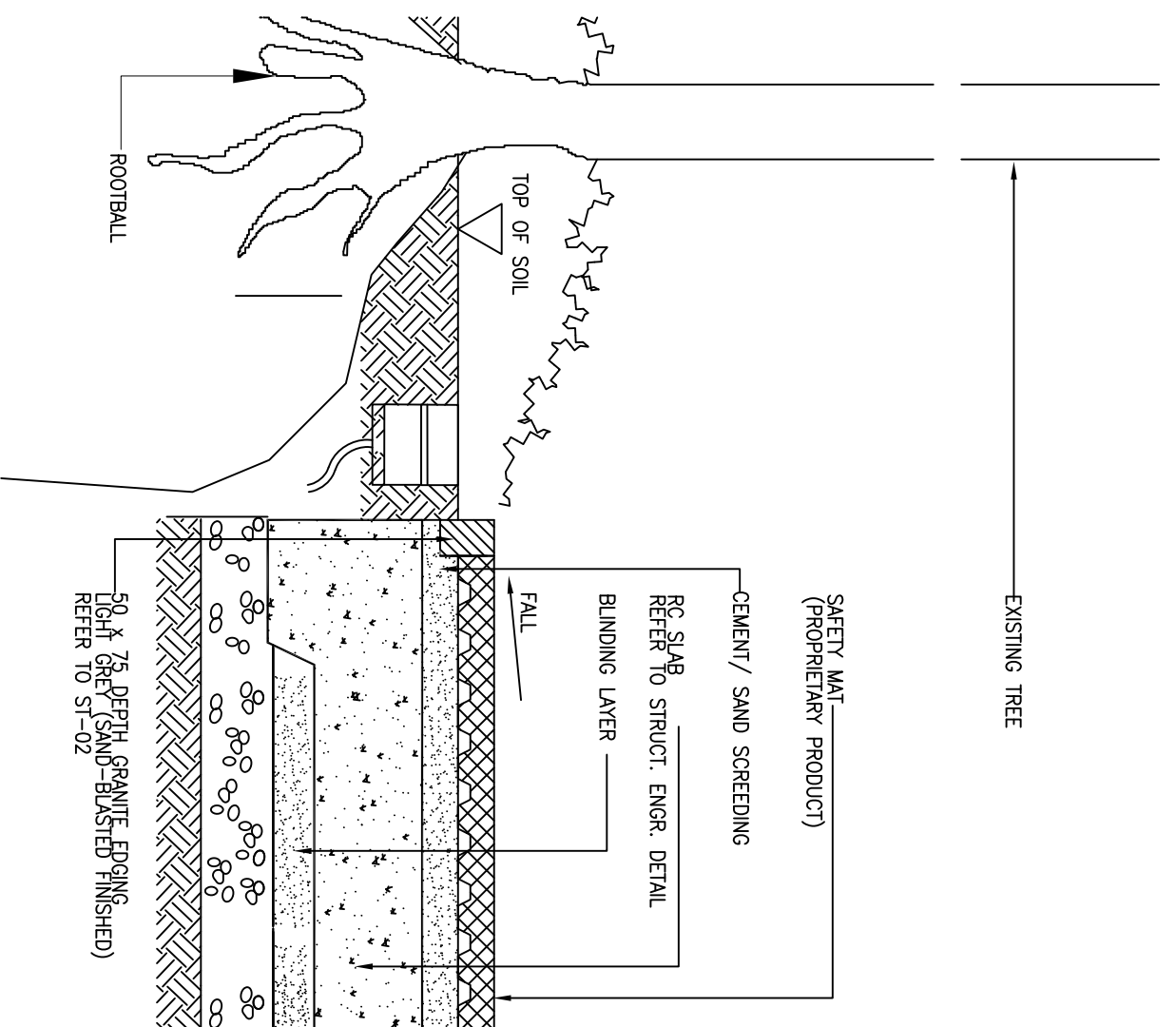

**D** PAVING INTERFACE DETAIL  
AT FITNESS STATION  
SCALE 1:10

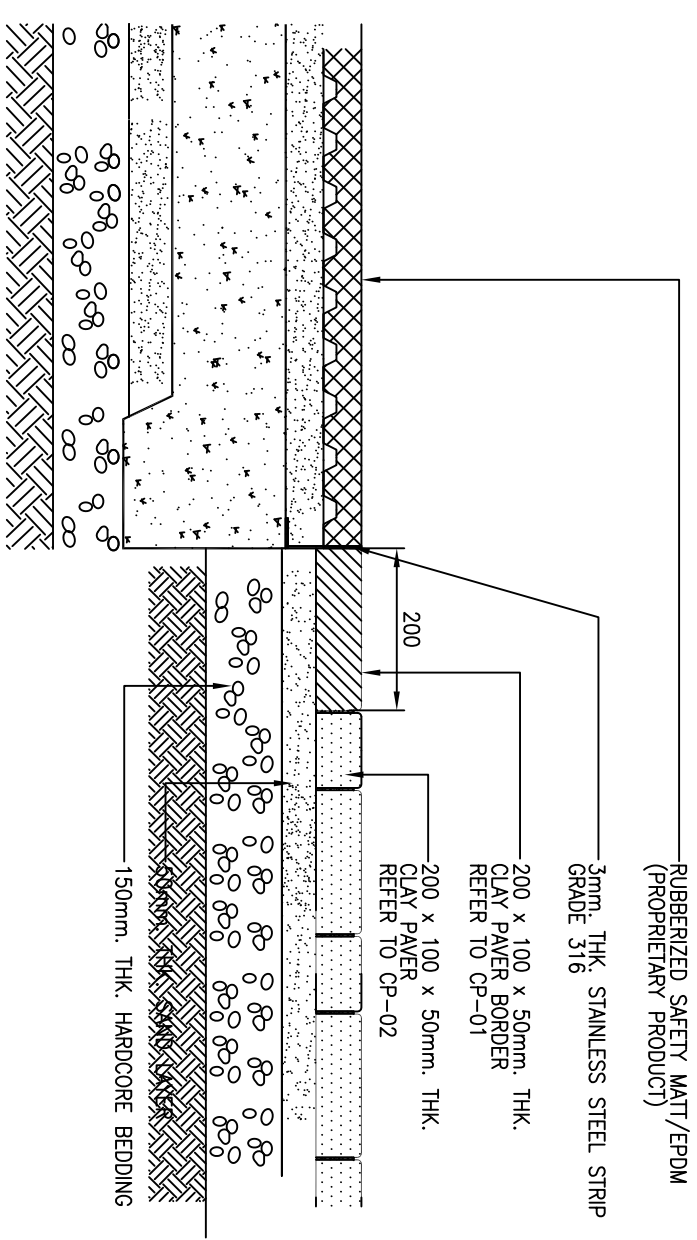

**B** PAVING INTERFACE DETAIL  
AT FITNESS STATION  
SCALE 1:10

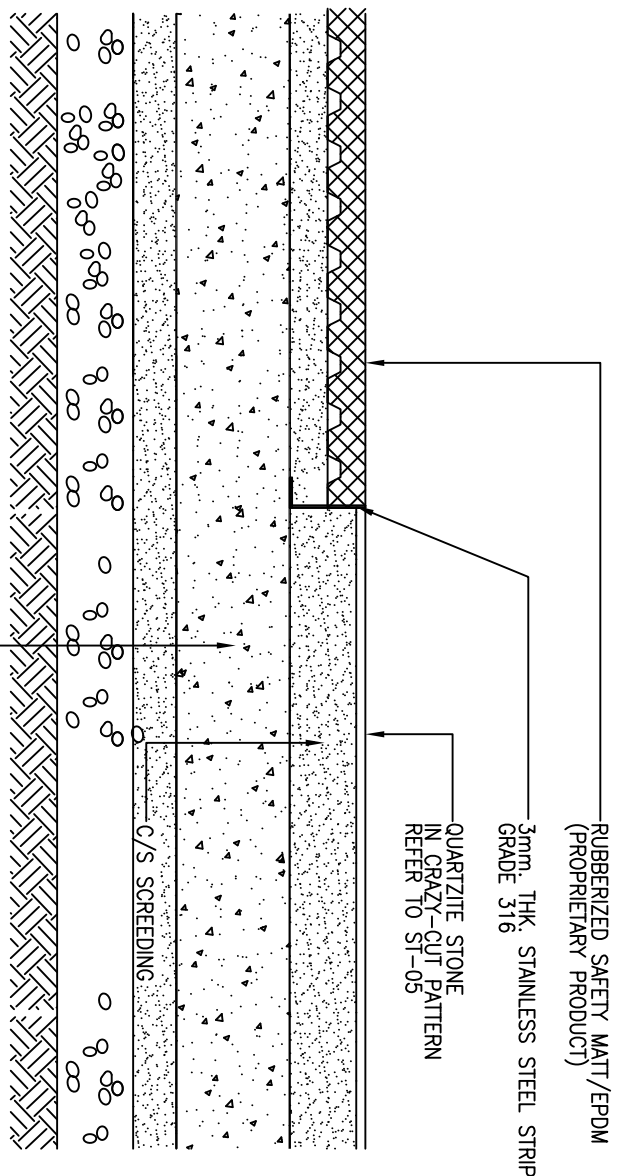

**C** PAVING INTERFACE DETAIL  
AT FITNESS STATION  
SCALE 1:10

NOTE:  
 - CONTRACTOR TO LOCATE EXPANSION JOINT @ MAX. 15 PER LINEAR METRE & TO BE APPROVED BY ARCHITECT / STRUCTURAL ENGR.  
 - ALL SCREENING WATERPROOFING STRUCTURAL SLAB SHOULD REFER TO DRAWINGS.  
 - ALL DRAINAGE POINTS, CALCULATIONS & EXACT LOCATIONS OF SUB-SOIL DRAINS SHOULD REFER TO DRAINAGE CONSULTANT'S DRAWINGS.  
 - PAINTING SOUL & FINISHING MATERIALS SYSTEM SHALL BE SUPPLIED & INSTALLED BY SOFT LANDSCAPE SUB-CONTRACTOR.  
 - THE CONTRACTOR IS REQUIRED TO COORDINATE SPECIALTY THE LEVELS AMONG SOIL SURFACES, DRAINAGE, INSTALLATION OF SERVICES, FINISHING & PLANTING AREA.  
 - CONTRACTOR TO PROVIDE SHOP DRAWINGS, FINISHING & PLANTING AREA TO BE APPROVED BY ARCHITECTS APPROVAL.  
 - CUTTING OF STONE FOR PATTERN KEEP COMING SHOULD BE IN SEGMENT AND TO FOLLOW THE CURVATURE PROFILES.

No.	Date	Description	Initial
Revision			
Consultant Project No. 080101			

**ARTHUR C. S. KWOK ARCHITECTS & ASSOCIATES LIMITED**  
 郭定輝建築師事務所  
 1401 AVONLE CENTRE ONE KOWLOON

**TEAM 73 HK Limited**  
 Urban design urban planning landscape architecture  
 城市設計 城市規劃 景觀建築  
 73 TEAM 73 LIMITED  
 73 建築師事務所有限公司  
 16/F, 433 LANTAO ROAD, SHEWAN TOWER, KOWLOON  
 電話: (852) 2500 1238  
 傳真: (852) 2500 1239  
 網址: www.team73.com.hk

**THOMAS ANDERSON & PARTNERS (H.K.) LIMITED**  
 CONSULTING ENGINEERS BUILDING SERVICES

Name	Signed	Date
Designed	KH	08 DEC 2011
Drawn	RL	08 DEC 2011
Checked	SI	08 DEC 2011
Approved	SF	08 DEC 2011

Contract No.	
File No.	
Project No.	420 R0
Consultant Agreement No.	9AS022
Contract	LOCAL OPEN SPACE AT CHUNG YEE STREET, KOWLOON CITY DISTRICT
Drawing Title	PAVING INTERFACE DETAIL AT FITNESS STATION
Drawing No.	AB/2263/EW/119
Scale	AS SHOWN
	13 JUN 2012 (Date)

ARCHITECTURAL SERVICES DEPARTMENT